

Poly-carbonmonofluoride Lithium Batteries: Individual Specifications

BR-C

■ Dimensions(mm)

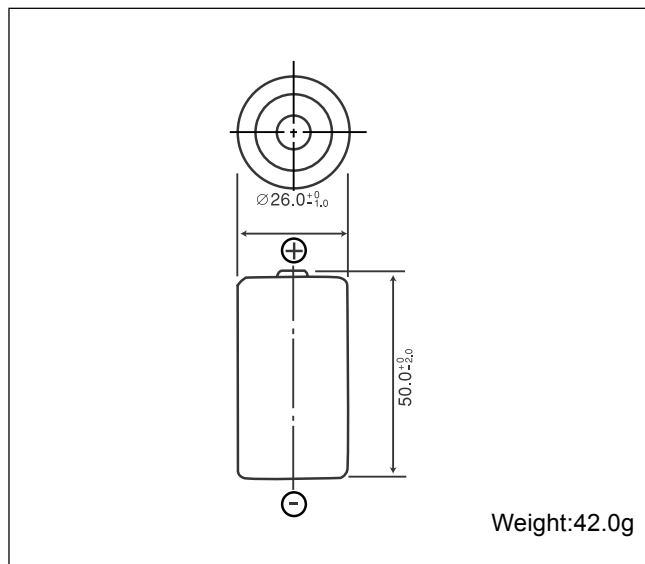

■ Specification

Nominal voltage (V)	3
Nominal capacity (mAh)	5,000
Continuous standard load (mA)	5.0
Operating temperature (C)	-40 ~ +85

■ Temperature Characteristics

